

## COMPANION

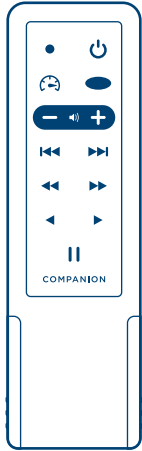

## EASY START

Connect earphones or speaker, press and hold the power button until the LED turns on. Companion will start to play automatically.

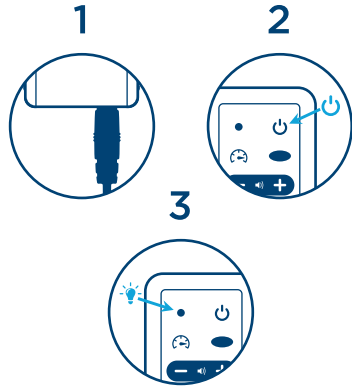

1

## TURNING THE PLAYER ON/OFF

Press on the front of the player for 2 seconds to turn the player on and begin playback mode (it will beep once). Press again for 2 seconds to turn the player off (it will beep twice).

*\*If no audio device is connected to Companion, playback will not begin until one is attached and is clicked.*

*\*\*While the player is on, a click on will perform a battery test. The LED will blink rapidly for 2 seconds indicating the remaining capacity (**Green**: 30-100%, **Yellow**: 10-29%, **Red**: 0-9%).*

*\*\*\*The battery test works for all battery types (see CHARGING INSTRUCTIONS).*

2

## SELECTING A CHANNEL

GREEN

While playing audio from one Channel, a 2-second press on will navigate to the beginning of the next Channel (if present). If a microSD card is loaded, the player will beep once and navigate to the card. See "USING THE microSD CARD" section.

*\*The LED is **green** while playback is from onboard memory, **red** when playback is from microSD.*

3

## NAVIGATING DURING PLAYBACK

Each Channel is subdivided into one or more Sections, containing one or more Books, containing one or more Chapters.

Click to skip to the next Section within the current Channel.

Click or to jump backward or forward one Book. A 2-second press will skip up to 5 Books at a time. Press and hold will continue until the first/last Book in the current Section is reached or the button is released.

Click or to jump backward or forward one Chapter. A 2-second press will skip up to 5 Chapters at a time. Press and hold will continue until the first/last Chapter in the current Book is reached

4

or the button is released.

Click or to jump backward or forward 20 seconds\* in the current file. A continuous press will perform a fast rewind/fast forward until the button is released or the beginning/end of the file is reached.

*\*The actual time skipped may vary slightly.*

## SPEED CONTROL

A click on will place the player in speed control mode, allowing you to adjust the speed for playback.

While in speed control mode, a click on or will adjust playback speed. The LED will alternate **red** and **green** as you change the speed. A continuous

5

press will decrease/increase until the minimum/maximum speed is reached.

To exit speed control and save the modified speed, click again. Pressing any other button will exit without saving changes.

To reset the speed to normal, enter speed control mode, then press again for 2 seconds. Player will return to playback mode.

*\*While in speed control mode, player will play a low beep every 10 seconds.*

*\*\*Companion will remember the modified playback speed even after it is turned off.*

6

## EARPHONES

The Companion does not include an internal speaker. Insert an earphone or speaker plug into the standard 3.5mm stereo audio jack on the bottom of the player.

Click or to lower or raise volume. The Companion will always remember the last volume setting.

*\*Whenever an audio device is connected or disconnected, Companion enters pause mode.*

*\*\*If Companion is turned on without an audio device connected, it automatically enters pause mode.*

7

## PAUSING/ BOOKMARKING

Companion supports a total of 7 playback bookmarks.

While in playback mode, click to enter pause mode (playback will suspend and the LED will blink intermittently).

A click on any of the buttons will resume playback from the bookmark previously associated with that button.

A 2-second press on any of the buttons will set (or reset) a bookmark to the current audio position (player beeps once).

The default bookmark, which is used to resume playback when the player is turned on, may be set with a 2-second

8

press on (player will beep 3 times).

To resume playback from pause mode, click .

*\*If Companion is paused for more than 15 minutes, it will beep twice and turn itself off.*

## RESETTING THE DEFAULT BOOKMARK

To reset the default bookmark to the beginning of the messages, do the following:

1. While the player is on, click the button.
2. Once in pause mode, press the button for 2 seconds (player will beep once).

9

- The default bookmark is now reset to the beginning. You may resume playback or turn player off.

## USING THE MICROSD CARD

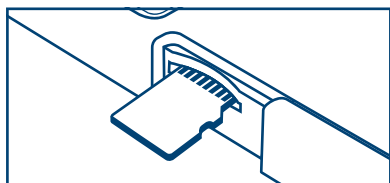

The Companion can also play audio from a properly structured microSD card.

With the player facing you, and the sliding cover open, insert the card with the brass contacts showing until it snaps in place.

10

Once a card is loaded, press  for 2 seconds repetitively until the player beeps once.

Playback will now begin from the card.

*\*During playback from microSD the LED is red.*

To remove a card, gently push it in. The reader will release and push it out so you can remove it. If the player was in playback mode from the card when removed, it will beep once and revert to the onboard memory.

You can view, format and prepare a microSD card while loaded in the Companion's microSD card reader when the player is connected to a Computer using a USB to micro-USB cable. You may also do the same with the card loaded in a microSD adapter connected to a Computer.

11

## CHARGING INSTRUCTIONS

The Companion can be powered by an AAA-shaped rechargeable Lithium-Ion battery, a disposable AAA battery or a rechargeable\* AAA battery.

*\*Requires external charger (not included).*

With proper care, the Companion's Lithium-Ion battery should perform well for several years. When shipped, the battery is only partially charged. Please fully charge the player before the first use following one of the charging methods below:

 For fastest charge, connect any standard "USB" charger (regulated +5VDC, minimum 300mA) to the micro-USB port on the player for about 1 hour\*

12

or until the LED stops blinking. While charging, the LED will blink according to the charge level (**Green**: 30-100%, **Yellow**: 10-29%, **Red**: 0-9%).

 Plug player into any standard computer USB port using a "USB to micro-USB" cable for about 3 hours\* or until the LED stops blinking.

*\*Actual charge time will vary according to the current battery capacity.*

## BATTERY CARE

- Avoid completely depleting the battery as this will shorten its overall lifetime and takes much longer to fully charge afterwards.
- When not in use and whenever possible, keep the player in a cool

13

place, which will also help to preserve battery life.

- Before stowing the player for prolonged periods, make sure the battery is at least partially charged.
- If stored for *extended* periods, it is recommended to recharge the player at least every 6 months, in order to prevent the battery from losing its ability to recharge.
- Should the battery become defective and unable to accept a charge, it is still possible to operate the player using a USB cable connected to a computer or an electric charger.

14

## CHARGING/ COMMUNICATION MODES

When connecting the Companion to a computer, it can be done in one of two modes: charging\*\* or communication.

*\*Changing to computer communication mode is essential to allow programming of the player.*

### Connecting a player to a computer for programming purposes:

Connect the player to a computer using a micro-USB SLS cable (for onboard/microSD programming) or Standard micro-USB Data cable (for microSD programming only). The player will automatically enter *computer*

15

*communication mode\*.*

*\*While in computer communications mode, the player will also be charging\*\*.*

### Connecting a player to a computer for charging\*\* purposes:

Connect the player to a computer using a micro-USB SLS cable, a Standard micro-USB Data cable or a Charge Only micro-USB cable.

- If connected via SLS/Data cable, and you want to disconnect from computer communication mode and continue charging your player, click  on the front of the player. If the player was on prior to connecting it to the computer, the player will return to playback mode.

° For the computer to recognize the player again, the player will need to

16

be unplugged from the computer, and reconnected.

- Depending on the connection type, and the player's battery level, the LED will blink (indicating communication activity or charging level).
- Physically unplugging the player from the computer will stop the battery charging process.

*\*\*When equipped with the Lithium-Ion battery.*

## RESETTING PLAYER DEFAULTS

Resetting player defaults (listed below) is done by pausing the player and pressing  for 2 seconds (player will beep 3 times and remain in pause mode).

17

- Default playback bookmark (to beginning)
- Volume level (to normal)
- Playback speed (to normal)

## PROBLEMS WITH THE PLAYER?

If Companion will not play, first make sure the battery is charged according to "CHARGING INSTRUCTIONS" (if equipped with Li-Ion battery) or simply replace the AAA battery.

If the battery is good and it still will not play, it may require rebooting. Press the  button for 10 seconds until the player turns off. It will turn on automatically after a reboot.

18

If none of the above succeeded, please contact your sales representative for support.

## WARNINGS



- Care must be taken to set the volume at the lowest level that can be heard comfortably. Prolonged exposure to loud sound can cause gradual hearing loss.
- DO NOT expose player or battery to fire/extreme heat.
- Stop using player if you observe abnormal heat, odor, discoloration, leakage or deformation, especially near battery. Refer to a qualified technician for service.

19

- If the battery is removed from the player, handle it with care. Keep the exposed battery out of reach of children. DO NOT burn, puncture, disassemble, or modify battery.
- If battery leaks, dispose of it carefully in accordance with all local laws. Wash any skin or clothing exposed to battery liquid and avoid swallowing or contact with eyes. In the case of swallowing or contact with eyes, seek medical care immediately.

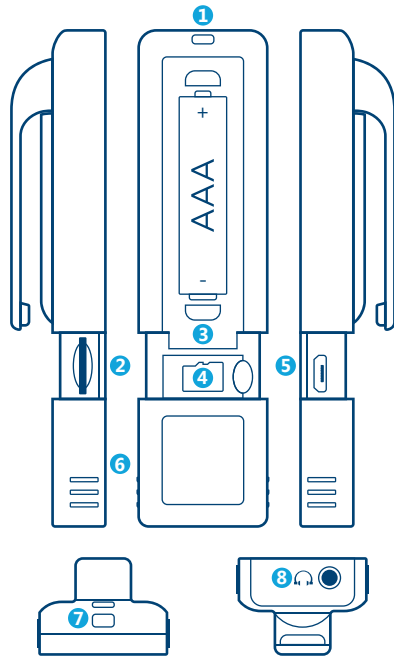

## OTHER SIDES

- 1 Belt clip removed in back view
- 2 MicroSD card reader
- 3 Tab for battery compartment access
- 4 MicroSD card storage
- 5 Micro-USB port
- 6 Sliding cover
- 7 Lanyard hole
- 8 3.5mm stereo audio jack

